



Solutions for closets and home storage



## *Life + Style*

ClosetPlace wants you to love your closet!

Select from a variety of textures, colors and styles in solid wood and laminate materials for a truly custom solution for any storage space in your home.

We are a locally owned, independent dealer helping to organize NH homes since 2004. Your new closet or built-in will be crafted in New Hampshire and guaranteed for as long as you own your home.

## More Than Closets

- Closets
- Custom Built-ins
- Home Office
- Pantries
- Mudrooms
- Laundry rooms
- Entries
- Garages



## Practical Solutions



# HARDWARE

## CLOSET RODS



Polished Chrome



Matte Black



Matte Nickel



Matte Gold

## DRAWER PULLS

### Elite Handle



### Transitional Handle



### Elite Bow Handle



### Elite Drop Handle



### Elite Edge Pull





### Modern Handle



### Traditional Knob



### Classic Square Knob



### Transitional Knob



### Finger Pull



### Garage Handles-7"



### So-Ho



## DOOR AND DRAWER STYLES

Flat

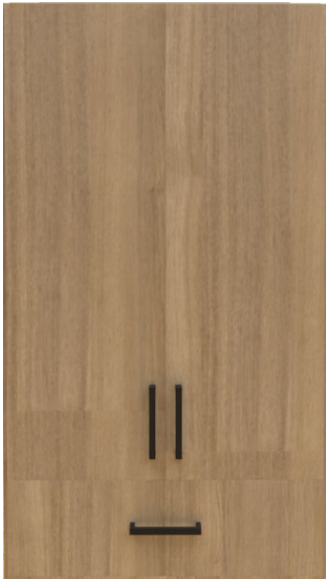

Shaker



Shaker Glass



Raised Panel



## DRAWER BOXES and SLIDES

We offer three price levels of drawer boxes and slides. All options are beautiful and durable.



Standard Slide



Side Mount Soft Close



Under Mount Soft Close

Scoop front come with standard slides



Scoop Front



Maple Melamine



Baltic Birch Dovetail



Solid Maple Dovetail

# Accessories



Tilt-out Hamper



Swivel Mirror

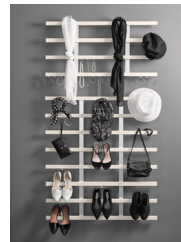

Symphony



Jewelry Tray



Tie Rack



Belt Rack



Valet Rod

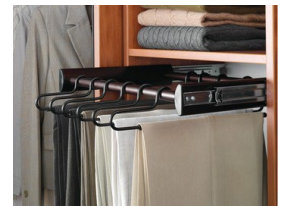

Pants Rack



Hamper

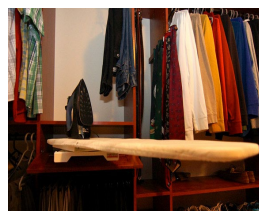

Ironing Board



Baskets



Single hook



Belt Hook



Double Hook



Tie Hook



Waterfall

## Colors

			
White	Ivory	Morning Dew	Shadows
			
Calm Sea	Sunflower	Latitude North	Candlelight
			
Hard Rock Maple	Rustik Cherry	Sheer Beauty	River Rock
			
First Light	Chameleon	Après Ski	Tea for Two
			
Sugar on Ice	Winter Fun	Weekend Getaway	Summertime Blues



# Our Process

**Short Lead times:** Once you have approved your final design your closet is usually installed within four weeks.

**Solid Wood Built-ins:** Some custom wood cabinetry may take up to 8-10 weeks depending on the style, color or complexity of the job.

**Custom options:** Von Goethe once said, "Whatever you can do, or dream, you can begin it. Boldness has genius, power, and magic in it." We can add custom options to any closet. If you want to get creative with shoe storage, door inserts, roll-out accessories, moldings or anything else you can imagine—let us help you bring your dream closet to life.

For more inspiration visit <http://www.closetplace.com/> or view our recent projects at [www.houzz.com/pro/bill-huntley/closetplace](http://www.houzz.com/pro/bill-huntley/closetplace).

Denise and I look forward to working with you.

Sincerely,

*Bill Huntley*

